



**AESSEAL
NEW YORK
STADIUM**
CONFERENCE & EVENTS

Who We Are & What We Do

Home to Rotherham United Football Club since 2012, the AESSEAL New York Stadium is one of Yorkshires iconic venues, hosting large scale conferences, exhibitions, and events.

The area of Rotherham where the ground is located is historically known as New York (hence the stadium name) and is built on the site of the old Guest & Chrimes factory.

Enriched with some of the finest modern day facilities, the stadium's versatility and desire to ensure that every single person has a truly memorable experience is second to none.

The stadium has built a tremendous reputation as a market leader in the hospitality and events industry.

The AESSEAL New York Stadium is the perfect backdrop for large scale conference, exhibitions, dinners, roadshows etc.

The stadium offers an array of suites that can host anywhere from 2 people to 500 guests.



A Central Location

The AESSEAL New York Stadium has become Rotherham's defining landmark - well known and admired throughout the region and a focal point for close on half a million visitors per year.

Rotherham's central location means that the AESSEAL New York Stadium is easily accessible from all parts of the UK, situated close to Junctions 33 and 34 of the M1 motorway.

For those travelling by public transport the stadium is a 10 minute walk from both the Railway Station & Bus Station. Doncaster Sheffield Airport is a 45 minute drive away.

3

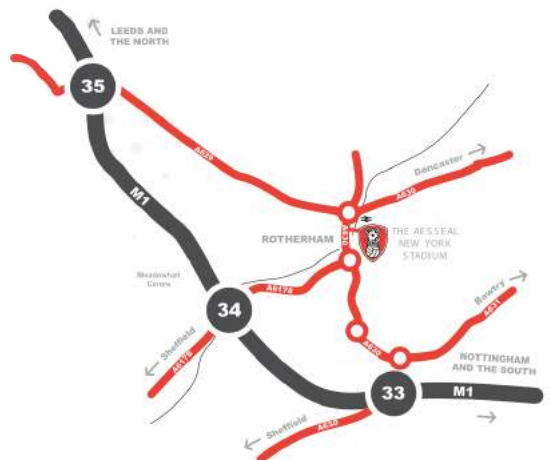

Meeting Spaces

The fully accessible multi-purpose facilities all have natural light and lend themselves to a wide range of events from corporate hospitality, conferences, meetings, seminars, product launches, exhibitions and training.

4

All rooms are pitch facing presenting you with a stunning view of the ground.

The food delivered at your corporate event is top-notch and prepared by our specialist trained chefs. The menu on the day can be tailored to suit your requirements whether you require simple refreshments, light lunches, hot or cold buffets or a sit down meal



Level 1 - 1925 Suite

(Brooklyn, Central Park, Manhattan)

One of AESSEAL New York Stadium's biggest suites is versatile, capable of stunning transformations depending on the event.

The suite is incredibly adaptable with the flexibility to split into three sections. It can support hosting conferences up to 500 delegates as well as a breadth of other event styles that are able to support large scale event deliveries.

Accessible via lifts and stairs to the first floor, the 1925 Suite is perfect for large-scale gatherings

5

Capacities

1925 Suite	
Theatre	500
Cabaret	320
Boardroom	40
U-shape	40
Reception	420
Lunch/Dinner	350
Dinner Dance	320

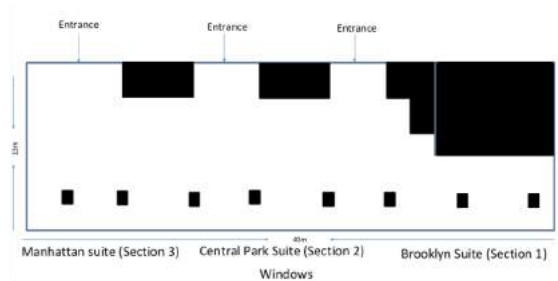



Level 2 - New York Suite

(Silver Lounge, Boardroom, Guest Lounge)

6

The iconic New York Suite boasts an entire wall of floor to ceiling windows showcasing the pitch and Rotherham skyline.

The suite can host a whole range of event types for up to 500 delegates. The suite itself contains no pillars so offers complete unimpeded views to all guests, and has the flexibility and ease of being divided into three smaller sections which are perfect for individual events or for additional breakout space for workshop groups.

Capacities

New York Suite	
Theatre	500
Cabaret	320
Boardroom	40
U-shape	40
Reception	420
Lunch/Dinner	350
Dinner Dance	320

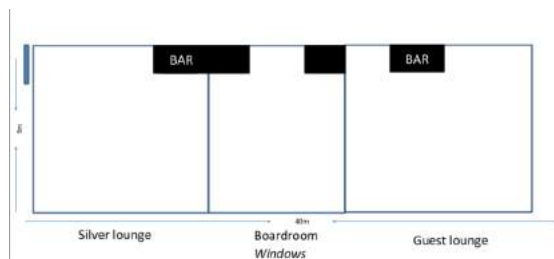



Executive Boxes

Our 8 smaller hospitality boxes allow us to offer you a little something extra, whether that be an additional breakout space at your company conference or a private area for a meeting. The beautifully decorated rooms provide an intimate space perfect for generating those additional ideas. They're positioned well with easy access to all suites and can be added onto any package or hired individually.

They all come with a TV screen ready for your presentations and branding. The view out onto the pitch creates a relaxing and quiet environment that works well for virtual meetings, 1-2-1's, and of course that all important networking. With the view, the atmosphere and high-end service you'd be crazy to disqualify them.

7

Capacities

Executive Boxes	
Theatre	25
Cabaret	10
Boardroom	10
U-shape	0
Reception	0
Lunch/Dinner	0
Dinner Dance	0

*For more information or to book
please call: 01709 827 780
or email: aessealnys-events@elior.co.uk*

